

Design Number LII/FIP 120-01
Non-Load Bearing Wall System
LaPolla Industries, Inc.
Foam-LOK™ FL 2000
ASTM E 119 (2009C)
Rating: 2 hour

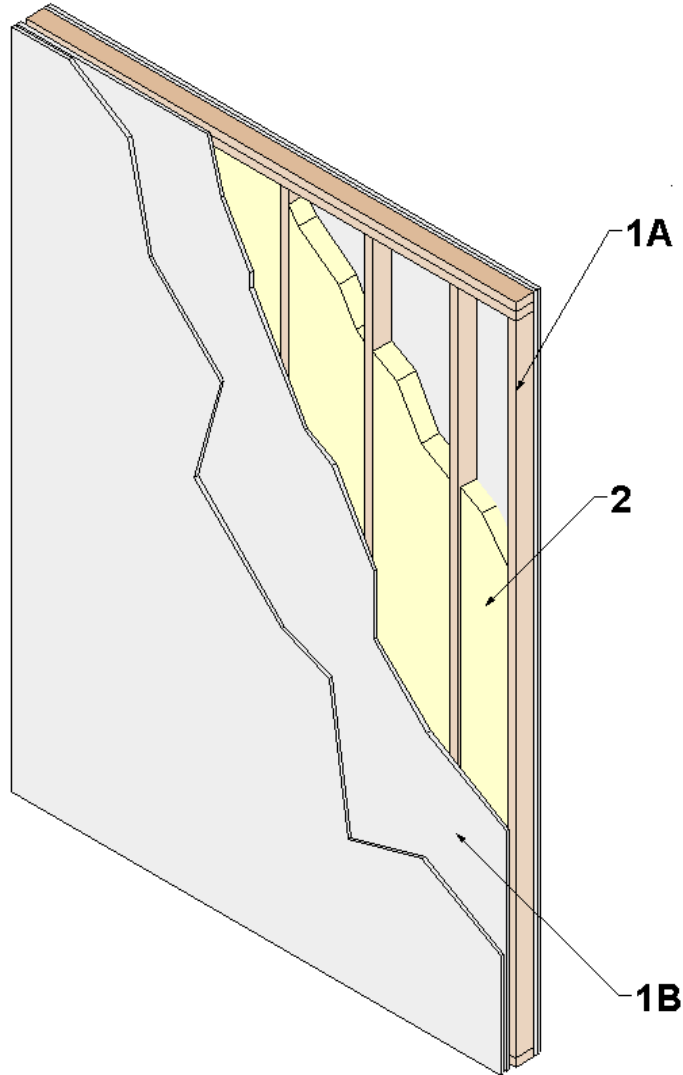

1. WALL ASSEMBLY: Construct 2- hour rated gypsum wall assembly using the following elements:

- A. WOOD STUDS: Install nominal 2-inch X 4-inch Number 2 Southern Yellow Pine wood studs spaced maximum 16-inches on center.

Attach each wood stud to top and bottom wood plates using two (2) 3-inches x 0.120-inch smooth shank nails. Construct top plate of 2 wood studs installed horizontally at the top of the gypsum wall assembly and the bottom plate of a single wood stud.

- B. GYPSUM BOARD: Install two layers of 5/8-inch Type X gypsum board oriented vertically to both sides of the wood studs (Item 1A). Install face layer of the gypsum board over base layer of the gypsum board with minimum 24-inch overlaps at vertical joints. Secure base layer of gypsum board to the wood studs (Item 1A) using 1-5/8-inch coarse thread drywall screws spaced 8-inches on center around the perimeter and 12-inches on center in the field. Install the face layer of the gypsum board over the base layer with vertical joints offset minimum 24-inches. Secure face layer using 2-inch coarse thread drywall screws spaced 8-inches on center around the perimeter and 12-inches on center in the field.
- C. JOINT TAPE AND COMPOUND: (Not Shown) After gypsum board (Item 1B) is attached, apply a level 2 finish consisting of the following elements: Vinyl or casein, dry or premixed joint compound to face layers of gypsum board in two coats to all exposed screw heads and gypsum board butt joints. Embed a minimum 2-inch wide paper, plastic, or fiberglass tape in first layer of compound over butt joints of the gypsum board. Install gypsum board with the following specifications:
2. CERTIFIED COMPANY: LaPolla Industries, Inc.
CERTIFIED PRODUCT: Polyurethane Foam Insulation
MODEL: Foam-LOK™ FL 2000
- INTERIOR WALL INSULATION: Install a nominal 3.5-inch thick, 2 (\pm .15) pcf density layer of Foam-LOK™ FL 2000 polyurethane foam applied over the gypsum board (Item 1B).